



# AIRCHARGER™

## HIGH-FLOW INTAKE KITS



### INSTALLATION INSTRUCTIONS

**63-1119**  
**YAMAHA**  
**2004-07 RHINO**  
**660cc**

**TOOLS NEEDED:**

- Flat Blade Screwdriver
- Ratchet
- Extension
- 17mm Socket
- 7/16" Socket
- 17mm Wrench
- 10mm Wrench
- 4mm Allen Wrench

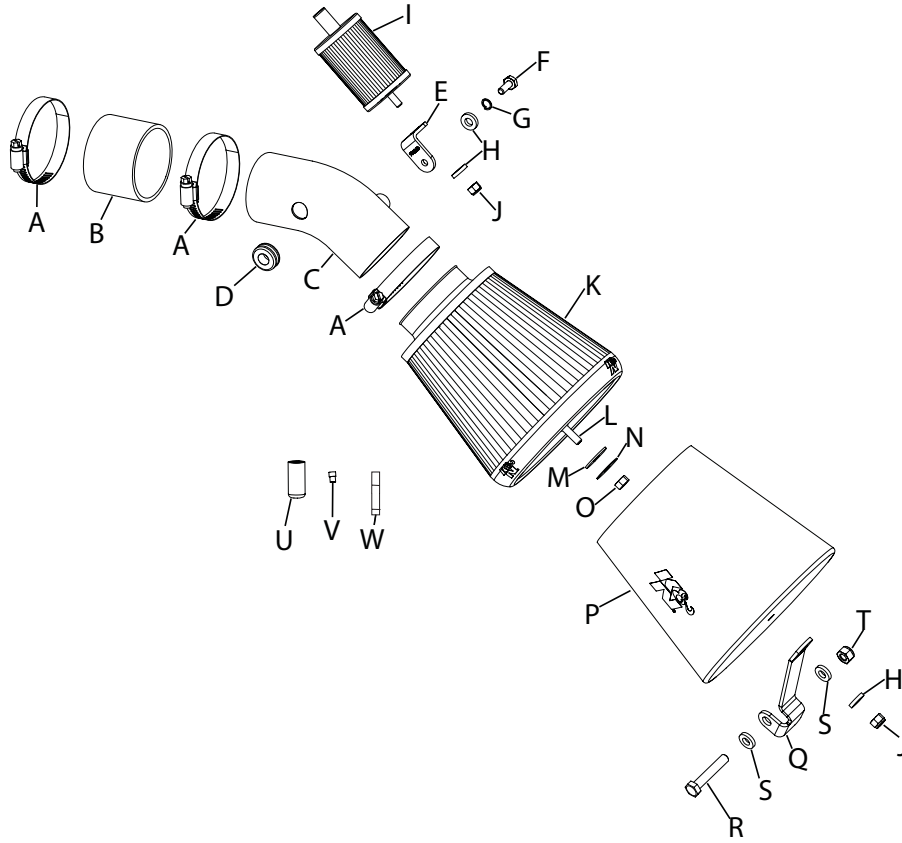

**PARTS LIST:**

Description	Qty.	Part #
A	3	08554
B	1	08284
C	1	27526
D	1	08092
E	1	070066
F	1	07812
G	1	08198
H	3	08275
I	1	62-1300
J	2	07517
K	1	RX-3810XD
L	1	08314
M	1	21685
N	1	08160
O	1	07681
P	1	RX-3810DK
Q	1	26659
R	1	07873
S	2	08276
T	1	07545
U	1	08120
V	1	34m170
W	1	482

**NOTE:** The K&N® Drycharger® included with this kit must be installed on the K&N® air filter because of the harsh terrain conditions these vehicles are intended to operate in. Please be aware the Drycharger® is water repellent, not water proof. The K&N® high flow intake system is a performance product that can be used safely during mild and inclement weather conditions if used as directed. Failure to follow these instructions can void your warranty.

**NOTE: FAILURE TO FOLLOW INSTALLATION INSTRUCTIONS AND NOT USING THE PROVIDED HARDWARE MAY DAMAGE THE INTAKE TUBE, THROTTLE BODY AND ENGINE.**

**TO START:**

1. Turn off the ignition and disconnect the negative battery cable.



2. Release the locking lever and remove the two passenger seats from the vehicle.



3. Unhook the engine cover, lift and remove the engine cover from the vehicle.



4. Remove the front two air box retaining clips shown.



5. Unhook the carburetor slide vent hose from the carburetor as shown.



6. Unhook the crank case vent hose from the factory air box as shown.



7. Loosen the hose clamp that secures the intake tube to the carburetor and then remove the complete intake system as shown.  
**NOTE: K&N Engineering, Inc., recommends that customers do not discard factory air intake.**



8. Release the shifter drain hose clamp and remove the drain hose from the shifter assembly as shown.

**NOTE: The spring clamp will be reused.**



9. Install the supplied nylon plug onto the shifter drain tube and secure with factory clamp.



10. Install the filter mounting bracket onto the engine boss as shown with the provided hardware.  
**NOTE: Do not completely tighten at this time.**





11. Install the silicone hose (08284) onto the carburetor and secure with the provided hose clamp.

11a. Following the factory Yamaha instructions, remove the carburetor from the vehicle, then remove and replace the factory main jet with the 170 main jet supplied.

**NOTE: It may be necessary to adjust to different jet sizes depending on altitude and atmospheric conditions.**



12. Remove the rubber plug shown from the filter top.



13. Install the supplied 1/4-20 bolt through the filter top and secure with the supplied rubber washer, fender washer, and standard nut as shown.

**NOTE: Apply the supplied thread locker to the bolt and nut.**



14. Install the supplied grommet into the K&N® intake tube as shown.



15. Remove the carburetor slide vent hose and 90° fitting from the stock intake tube as shown.



16. Install the carburetor slide vent hose assembly into the grommet in the K&N® intake tube as shown.



17. Install the "L" bracket (070066) onto the K&N® crank case breather filter as shown.

**NOTE: The slotted end of the bracket is to be secured to the filter.**



18. Install the crank case breather assembly onto the K&N® intake tube as shown with the provided hardware.



19. Install the K&N® air filter onto the intake tube assembly and secure with the provided hose clamp.



20. Using a sharp instrument, poke a hole in the center of the reinforcement patch of the K&N® Drycharger®.



21. Install the K&N® Drycharger® onto the K&N® air filter.

**NOTE: Please be aware the Drycharger® is water repellent, not water proof. Depending on conditions and usage the water repellent treatment is good for 1 to 2 years. See the parts list to reorder a new Drycharger® if necessary.**



22. Install the K&N® intake assembly into the silicone hose at carburetor and align with the filter mounting bracket installed during step #9.



23. Secure the filter mounting bracket to the filter with the hardware provided. Then secure the tube to the silicone hose with the hose clamp provided.



24. Install the carburetor slide vent hose onto the carburetor port as shown.



25. Install the crank case vent hose onto the crank case vent filter as shown.





26. Double check to make sure everything is tight and properly positioned before starting the vehicle.



27. Reinstall the engine cover.



28. Reinstall the seats.

29. Reconnect the vehicle's negative battery cable.

30. It will be necessary for all K&N® high flow intake systems to be checked periodically for realignment, clearance and tightening of all connections. Failure to follow the above instructions or proper maintenance may void warranty.

#### ROAD TESTING:

1. Start the engine with the transmission in neutral or park. Listen for air leaks or odd noises. For air leaks secure hoses and connections. For odd noises, find cause and repair before proceeding. This kit will function identically to the factory system except for being louder and much more responsive.

2. Test drive the vehicle. Listen for odd noises or rattles and fix as necessary.

3. If road test is fine, you can now enjoy the added power and performance from your kit.

4. K&N Engineering, Inc., requires cleaning the intake system's air filter element periodically for excessive dirt build-up. When used in harsh terrain conditions or off-road environments, our filters will require cleaning more often. We recommend that you visually inspect your filter more frequently when used in harsh terrain conditions to determine if the screen is still visible. When the screen is no longer visible some place on the filter element, it is time to clean it. To clean and re-oil, purchase our filter Recharger® service kit, part number 99-5050 or 99-5000 and follow the easy instructions.

**STREET LEGAL IN MOST STATES**

**NOT LEGAL FOR USE IN CA & OTHER STATES  
ADOPTING CA EMISSIONS STANDARDS**

**See our catalog or [knfilters.com](http://knfilters.com) for CARB status on each part for a specific vehicle**

\* FREE K&N® decal To register your warranty, please see us online at [knfilters.com/register](http://knfilters.com/register). FREE K&N® decal \*